



BDB817
ID-Nr.: 57190
from Masch-Nr. 2368
for DK: ID 72439

status: 2022.01
replaced: 20.01

POS	IDNR	DESCRIPTION	qty
1	75838	OUTPUT SHAFT	1
2	16220	DEEP GROOVE BALL BEARING 6005 LLU	1
3	46474	SHAFT SEAL 25X40X7 DIN3760	2
4	51128	DISTANCE RING	1
5	38794	LOCKING RING J 42X1,75 DIN472	1
6	7401	DEEP GROOVE BALL BEARING 6004 2RS	1
7	52167	SHIM 30/42X1,5 DIN988	1
8	52175	SHAFT SEAL 20x42x7 DIN3760	1
9	21683	LOCKING RING A20 DIN471	1
11	37192	DISC SPRING 31,5X16,3X2	4
12	35790	BRAKE SEGMENT	2
13	46961	CLUTCH GEAR CPL.	1
14	13144	SHIM 16/22X1 DIN988	
14	7138	SHIM 16/22X0,1 DIN988	
14	7112	SHIM 16/22X0,2 DIN988	
14	40444	SHIM 16/22X0,5 DIN988	
14	51227	SHIM 16/22X0,6 DIN988	
14	51235	SHIM 16/22X0,7 DIN988	
15	75820	PRESSURE DISC	2
17	50997	PRESSURE DISC	1
18	51011	HEXAGONE SCREW M10X20 12.9 DIN912	1
19	50260	SCREW EJOT DELTA PT 5X100 TORXPLUS	4
20	7094	GEAR BOX 2-GG	1
21	42937	SEALING RING 1/8" only as spare part	1
22	55277	WATER CONNECTION CPL.	1
23	22590	BALL 6 DIN5401	1
24	56960	CLAMPING SLEEVE 3X6 DIN1481	1
25	8053	HEXAGONE NUT M5 DIN985 GALV	1
26	7343	GEAR LEVEL 2-GG	1
27	57992	O-RING 17X2,65	1
28	75382	GEAR HANDLE	1
29	9282	O-RING 4x2	1
30	21246	WASHER M5 DIN125 GALV	1
31	8047	HEXAGONE SCREW M5X18 DIN912 GALV	1
32	57083	COMPRESSION SPRING 5X0,8X17,5 D-135	1
33	22400	DEEP GROOVE BALL BEARING 629	2
34	1537	COUNTER SHAFT 11/18Z	1
35	48587	GEAR 27Z	1
36	23267	BEARING 10/14/12	2
37	1511	COUNTER SHAFT 19Z	1
38	1594	ADJUSTING SPRING 5X5X50 DIN6885	1
39	1529	DOUBLE GEAR 34/27Z	1
40	12724	FLAT SEALING	1
41	22103	CYLINDRICAL PIN 4X16 DIN7	2
42	48165	MOTOR HOUSING	1
43	48595	PINION 7Z Loctite638 on pinion thread	1
44	42713	DEEP GROOVE BALL BEARING 6201 2RS	1
45	21600	FAN	1
46	36004	ARMATURE 230V with 21600 and 5116	1
47	5116	INSULATION RING	1
48	22681	DEEP GROOVE BALL BEARING 6200 2RS	1
49	8042	AIR GUIDE RING SHORT	1



BDB817
ID-Nr.: 57190
from Masch-Nr. 2368
for DK: ID 72439

status: 2022.01
replaced: 20.01

POS	IDNR	DESCRIPTION	qty
50	7756	SCREW EJOT DELTA PT 4X90	2
51	9789	STRATOR 230V	1
52	9784	CAPACITOR	1
53	45443	MOTOR HOUSING	1
54	45872	CARBON BRUSH	2
55	52894	CARBON BRUSH HOLDER A3	2
56	45625	CARBON BRUSH COVER	1
57	7340	CARBON BRUSH WITH LIBELLA	1
58	21030	SCREW EJOT DELTA PT 4X12 TORXPLUS	2
59	58644	CABLE WITH PRCD SWIRTCH /PE	1
59	71274	CABLE WITH PRCD SWIRTCH /PE	only DK 1
60	25221	ANTI-KINK SLEEVE	1
61	20990	SCREW EJOT DELTA PT 4X16 TORXPLUS	5
62	17913	CABLE BRIDGE	1
63	32607	HANDLE CPL.	1
64	44941	SCREW EJOT DELTA PT 5X40 TORXPLUS	4
65	24844	SWITCH	1
66	35055	ELECTRONICS	1
67	15313	HANDLE PA 210MMLG	1
68	62331	WASHER M4 DIN433 GALV.	1
69	48918	PROTECTIVE CONDUCTOR	1
70	48280	SPRING RING A4 DIN127 GALV	1
71	48249	FLAT HEADED SCREW M4X6 DIN85 GALV	1
72	48512	GROUNDING MARK YELLOW / GREEN PVC	2
73	48504	CONNECTION CLAMP 1-P	1
80	57208	TYPE LABEL	1
80	72819	TYPE LABEL	only DK 1
81	31088	COMPANY SIGN	2
82	14290	WRENCH SW41	
83	43216	WRENCH SW36	
100	8495	TOOL CASE	
101	44867	CENTERING SUCTION PLATE	
102	60723	WATER PRESSURE CONTAINER	
103	70813	QUICK RELEASE RING 1 1/4"	

ERSATZTEILZEICHNUNG
SPARE PARTS DRAWING

Diamant-Naßbohrmaschine
DIAMOND WET CORING



BDB817 ab/*from* MaNr. 2368

IDNR. 5719
DK: 72439

Stand/status: 2022.01

ersetzt/*replaced*:2020.01

Pos. 14:
Vorgabe Kupplungseinstellung beachten
Observe default clutch setting

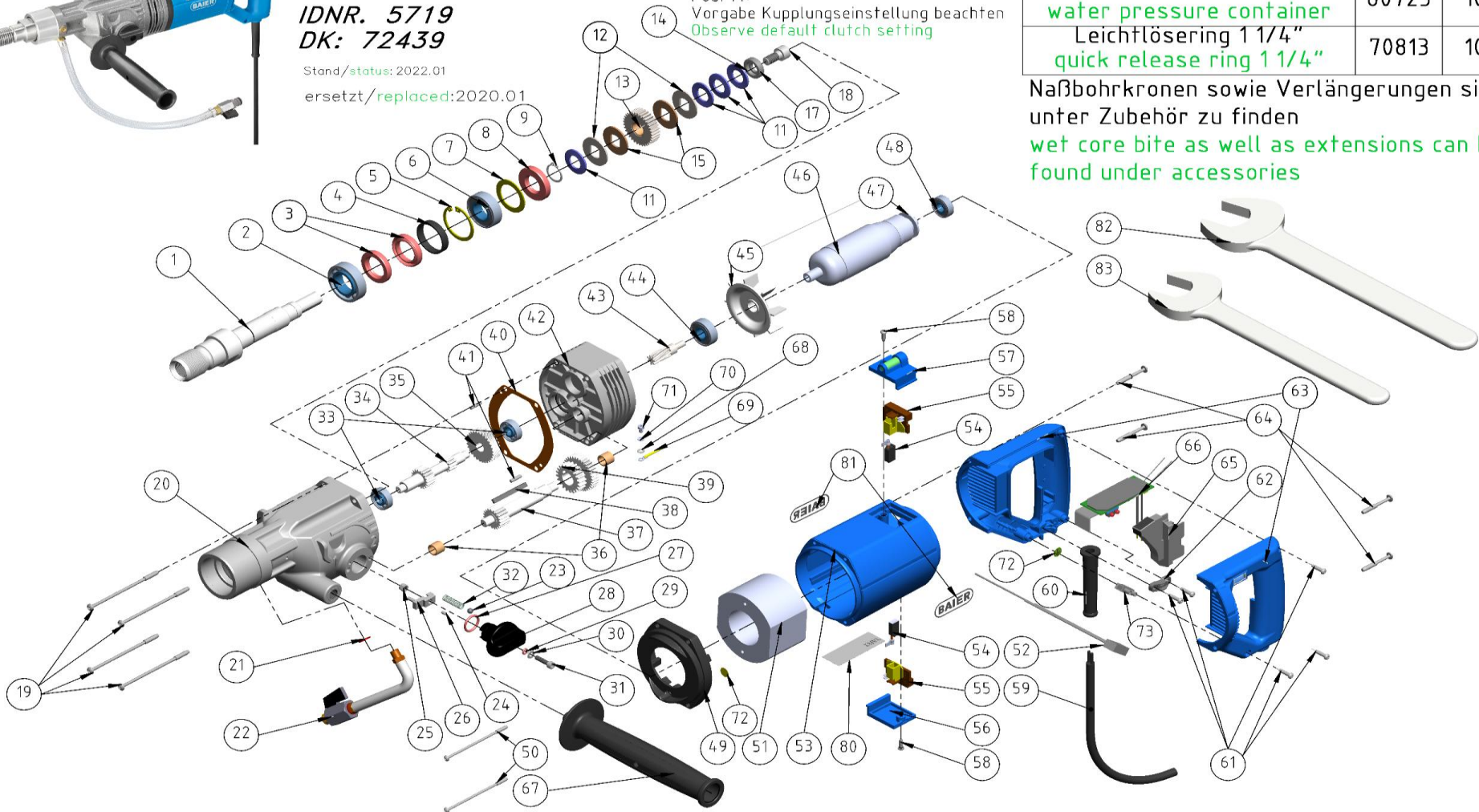

ZUBEHÖR ACCESSORIES	ID-Nr.	POS.
Transportkoffer <i>tool case</i>	8495	100
Zentriersaugplatte <i>centering suction plate</i>	44867	101
Wasserdruckbehälter <i>water pressure container</i>	60723	102
Leichtlösering 1 1/4" <i>quick release ring 1 1/4"</i>	70813	103

Naßbohrkronen sowie Verlängerungen sind unter Zubehör zu finden
wet core bite as well as extensions can be found under accessories