



POS	IDNR	DESCRIPTION	qty
1	65870	OUTPUT SHAFT	1
2	22475	BALL 4 DIN5401	1
3	66571	CYLINDRICAL PIN 4X18 GEH.	1
4	65904	CIRCLIP JL42	1
5	65920	NILOS DISTANCE RING J42 29X42X3	1
6	65912	NILOS RING 61905 JV 28X42X0,3	1
7	29744	DEEP GROOVE BALL BEARING LLU	1
8	37705	O-RING 18X3,5	1
9	52951	CIRCLIP SEEGER SW27	1
10	38794	CIRCLIP J 42X1,75 DIN472	1
11	52852	SHAFT SEAL 42X30X7 DIN3760	1
12	52878	SOFT IMPACT RING SHAFT	1
13	52886	SOFT IMPACT RING HOUSING	1
14	65888	GEAR HOUSING	1
15	33019	DEEP GROOVE BALL BEARING 6203	1
16	50716	CIRCLIP J 40 DIN472	1
17	51375	GEAR 35Z	1
18	59758	SHIFT ROD	1
19	9091	DECORATIVE CAP RED	1
20	60749	O-RING 13X2	3
21	9093	DECORATIVE CAP GREEN	1
22	50260	SCREW EJOT DELTA PT 5X100 TORXPLUS	4
24	22400	DEEP GROOVE BALL BEARING 629	2
25	76463	COUNTER SHAFT CPL.	1
27	12724	FLAT SEALING	1
28	22103	CYLINDER PIN 4X16 DIN7	2
29	61192	MOTOR COVER	1
31	42713	DEEP GROOVE BALL BEARING 6201 2RS	1
32	21600	FAN	1
33	6481	ARMATURE 230V	1
34	5116	INSULATION RING	1
35	22681	DEEP GROOVE BALL BEARING 6200 2RS	1
36	14332	SHIM 16x10x0,5 DIN988	1
37	8042	AIR GUIDE RING SHORT	1
38	36137	SCREW EJOT DELTA PT 4X80 TORXPLUS	2
39	45856	STATOR 230V	1
40	45443	MOTOR HOUSING	1
42	45872	CARBON BRUSH	2
43	52894	CARBON BRUSH HOLDER A3	2
44	45625	CARBON BRUSH COVER	1
45	21030	SCREW EJOT DELTA PT 4X12 TORXPLUS	2
46	7340	CARBON BRUSH COVER WITH LIBELLA	1
47	25221	ANTI-KINK SLEEVE	1
48	24273	CABLE	1
49	17913	CABLE CLAMP	1
50	20990	SCREW EJOT DELTA PT 4X16 TORXPLUS	5
51	44941	SCREW EJOT DELTA PT 5X40 TORXPLUS	4
53	35055	ELECTRONICS	1
54	24265	SWITCH	1
55	32607	HANDLE CPL.	1
56	49684	HANDLE EXTENSION	1
58	15313	HANDLE PA 210MMLG	1



BDB822AP
ID-Nr.: 65896
from Masch.- Nr. 017534

status: 2026.01
replaced: 21.08

POS	IDNR	DESCRIPTION	qty
60	61127	WRENCH SW22/24	1
61	61556	NOTIFICATION SIGN (SOFT IMPACT)	1
62	6944	TYPE SIGN	1
63	31088	COMPANY SIGN	2
70	9652	SUCTION ADAPTER	
71	9651	CENTERING PIN	for #9652
72	8495	TOOL CASE	
73	53199	DRILL BIT SHAFT	
74	53207	SUCTION CAP	
75	70821	SEALING LIP	for #53207
76	34587	CENTERING PIN	for #53207
77	15453	SHARPING PLATE	
78		SINKER	see accesories



ERSATZTEILZEICHNUNG
SPARE PARTS DRAWING
Diamant-Trockenbohrmaschine
DIAMOND DRY CORING



BDB822AP ab/*from* MaNr. 17534
 IDNR. 65896

Stand/*status*: 2026.01
 ersetzt/*replaced*: 2021.08

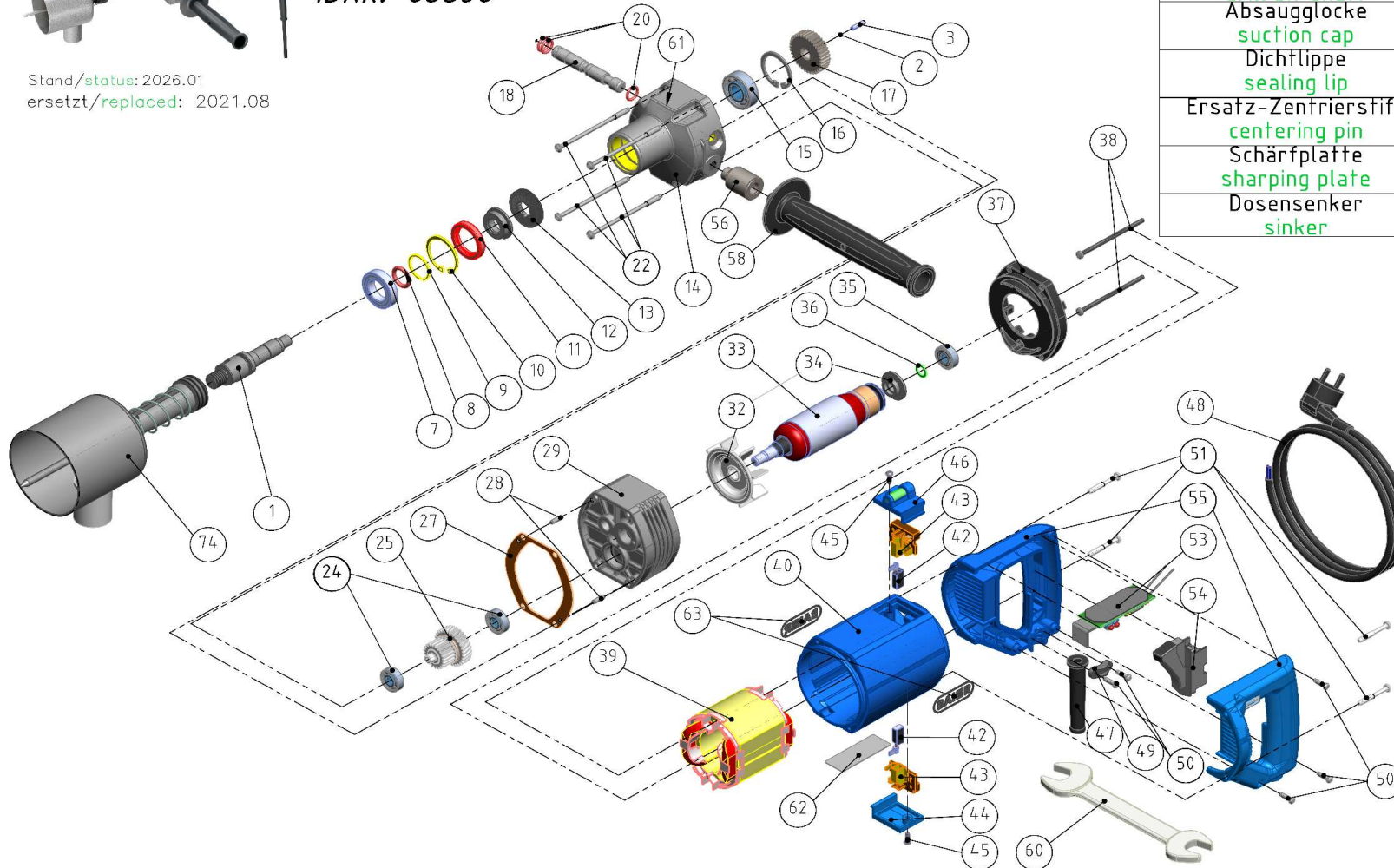

ZUBEHÖR	ID-Nr.	POS.
ACCESSORIES		
Saugadapter	9652	70
suction adapter		
Ersatz-Zentrierstift	9651	71
centering pin		
Transportkoffer	8057	72
tool case		
Bohrkronenschaft	53199	73
drill bit shaft		
Absaugglocke	53207	74
suction cap		
Dichtlippe	70821	75
sealing lip		
Ersatz-Zentrierstift	34587	76
centering pin		
Schärfplatte	15453	77
sharpening plate		
Dosensenker	siehe Kat.	
sinker	see cat.	