



BDB8295  
Drilling system  
from Masch.Nr. 10171  
ID-Nr.: 9842  
& 9955 & 10120

status: 2025.09  
replaced: 2021.03

POS	IDNR	DESCRIPTION		qty
1	6923	SUCTION PIPE CPL	consists of pos. 2, 3, 4, 5	1
2	59725	SUCTION PIPE		1
3	6809	SLIDING RING		1
4	59709	SPRING CLIP		1
5	59766	INFORMATION SIGN	only until 07/2022	1
6	9841	OUTPUT SHAFT CPL.		1
7	36640	CIRCLIP J 47X1,75 DIN472		1
8	62216	SHAFT SEAL 30X47X7 DIN3760		1
9	9150	CIRCLIP J 45x1,75 DIN472		1
10	16220	DEEP GROOVE BALL BEARING 6005 LLU		1
11	9111	SHIM 37x47x0.5 DIN988		1
12	7252	SHAFT SEAL 30X42X7 DIN3760 VIA		1
13	52878	SOFT IMPACT RING SHAFT		1
14	52886	SOFT IMPACT RING HOUSING		1
15	27557	DEEP GROOVE BALL BEARING 6203 2RS		1
16	50716	CIRCLIP J 40X1,75 DIN472		1
17	10085	DISTANCE SOCKET		1
18	9840	GEAR 35Z		1
19	21212	CIRCLIP A15 DIN471		1
20	9954	COUNTER SHAFT I 11/18Z BDB8295		1
	13144	SHIM 16x22x1 DIN988		1
	51235	SHIM 16x22x0,7 DIN988		1
21	40444	SHIM 16x22x0,5 DIN988		1
	61119	SHIM 16x22x0,3 DIN988		1
	7112	SHIM 16x22x0,2 DIN988		1
	7138	SHIM 16x22x0,1 DIN988		1
22	6333	CUP-SPRING 31,5X16,3X2		1
23	9952	PRESSURE DISC D32		1
24	9953	BRAKE SEGMENT		2
25	8632	CLUTCH GEAR 33Z		1
26	9950	PRESSURE DISC D30		1
27	76430	NUT M12x1		1
28	10442	COUNTER SHAFT I KPL. 11/118Z BDB8295		1
29	41376	SHIM 9x15x0,5 DIN988		1
30	50260	SCREW EJOT DELTA PT 5,0X100 TORX PLUS 25 GALV.		4
31	9838	GEAR HOUSING 2-GEAR BDB8295		1
32	12724	FLAT SEALING		1
33	22400	DEEP GROOVE BALL BEARING 629		2
34	23267	BALL BEARING 10/14/12		2
35	9949	COUNTER SHAFT 17Z BDB8295		1
36	1594	ADJUSTING SPRING 5X5X50 DIN6885		1
37	1529	DOUBLE GEAR 27/34Z		1
38	8954	GEAR SHIFTING GATE		1
40	22103	CYLINDRIC PIN 4X16 DIN7		2
41	10925	MOTOR COVER 2-GEAR without PE		1
42	10912	SHAFT SEAL 12X19X4 DIN3760 VIA		1
43	42713	DEEP GROOVE BALL BEARING 6201 2RS		1
44	21600	FAN		1
45	8638	ARMATURE 230V		1
46	22681	DEEP GROOVE BALL BEARING 6200 2RS		1
47	56960	CLAMPING SLEEVE 3x6 DIN 1481		2
48	22590	BALL 6 DIN5401		1
49	57083	PRESSURE SPRING 5X0,8X17,5 D-135		1
50	8053	HEXAGONE NUT M5 DIN 985		1
51	7345	SHIFT LEVER		1



BDB8295  
Drilling system  
from Masch.Nr. 10171  
ID-Nr.: 9842  
& 9955 & 10120

status: 2025.09  
replaced: 2021.03

POS	IDNR	DESCRIPTION		qty
52	57992	O-RING 17X2,65		1
53	75382	SHIFT LEVER		1
54	9282	O-RING 4X2		1
55	21246	WASHER M5 DIN125 GALV		1
56	8047	HEXAGONE SCREW M5X18 DIN912		1
57	36137	SCREW EJOT DELTA PT 4X80 TORXPLUS GALV		2
58	8042	AIR GUIDE		1
59	10059	STRATOR 230V		1
60	45443	MOTOR HOUSING		1
64	45872	CARBON BRUSH		2
65	10862	CARBON BRUSH HOLDER A3		2
66	21030	SCREW POLYPLAST 4,0X12 DIN7981 GALV		2
67	45625	CARBON BRUSH HOLDER COVER		1
68	7340	CARBON BRUSH HOLDER COVER WITH LIBELLA		1
69	20990	SCREW EJOT DELTA PT 4X16 TORXPLUS GALV		3
70	17913	CABLE CLAMP		3
71	75994	ELECTRONICS		1
71a	10859	ELECTRONICS WAS	only #9955	1
72	10057	CAPACITOR CPL.		1
73	64238	SWITCHING BRAID 1,5mm <sup>2</sup>		2
74	34124	PROTECTIVE CONDUCTOR 2-POLES		1
75	52803	COVER WITH LENS		1
76	25221	ANTI-KINK SLEEVE		1
77	36681	SWITCH		1
77.1	8463	COVER FOR PLUG SOCKET		2
78	27730	PAN HEAD TAPPING SCREW 4,8X70 DIN7981 GALV.		4
79	6430	CABLE 2X1,5mm <sup>2</sup>		1
79a	10845	CABLE 2X1,5mm <sup>2</sup> CH	only #9955	1
79b	57539	CABLE 2x1mm <sup>2</sup> with PRCD	only #10120	1
	34025	CABLE TIE		2
80	9948	TYPE SIGN BDB8295		1
80a	10060	TYPE SIGN BDB8295 CH	only #9955	1
80b	10119	TYPE SIGN BDB8295 PRCD	only #10120	1
81	31088	COMPANY LOGO		2
82	9947	DRY-CORING SIGN		1
83	6584	INSPECTION STICKER BGV A3		1
85	14290	WRENCH SW41		1
86	43216	WRENCH SW36		1
90	15453	SHARPING PLATE		



**ERSATZTEILZEICHNUNG**  
**SPARE PARTS DRAWING**

**Diamant-Trockenbohrmaschine**  
**DIAMOND DRY CORING**

**BDB 8295**

ab Masch.Nr. 10171

IDNR. 9842  
IDNR. 9995  
IDNR. 10120

Stand: 2025.09  
ersetzt: 2021.03

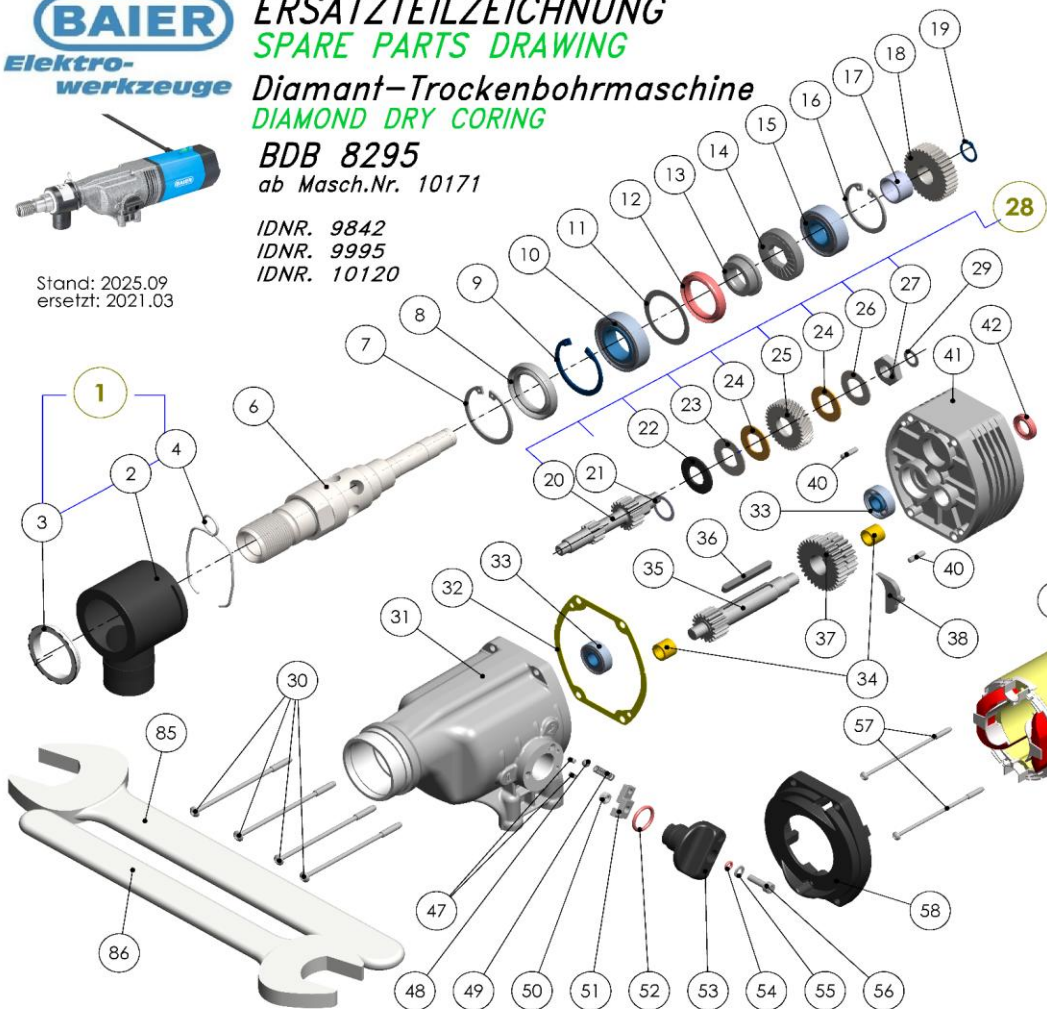

ZUBEHÖR ACCESSORIES	ID-Nr.	POS.
Schärfplatte sharpening plate	15453	90

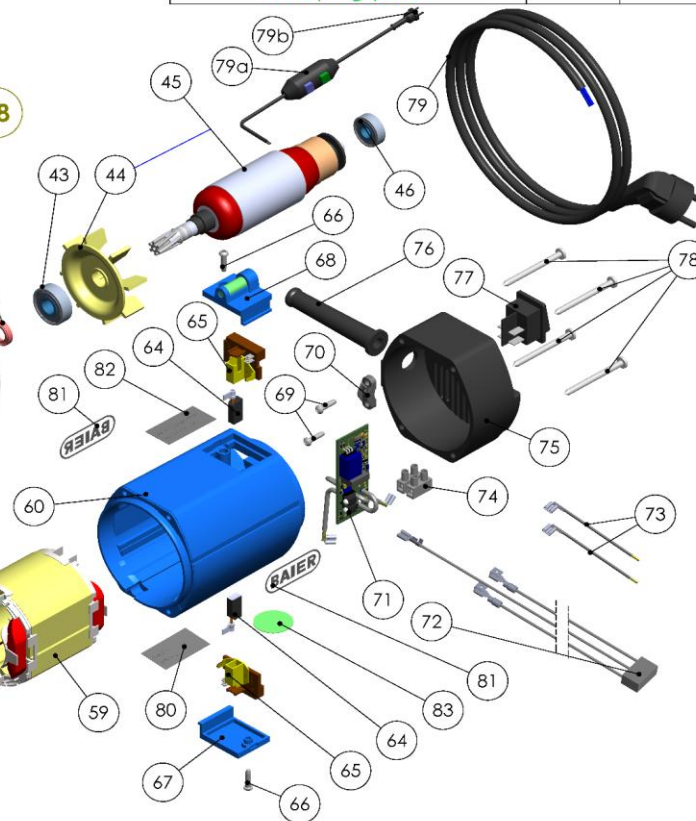

Trockenbohrkronen sowie Verlängerungen  
sind unter Zubehör zu finden  
dry core bite as well as extensions can be  
found under accessories