



BDB829

ID-Nr.: 9325 from MaNr.3282
also 9502 / 9904 CH

status: 2025.09
replaced: 2024.04

POS	IDNR	DESCRIPTION	qty
1	6923	SUCTION PIPE CPL.	1
2	59725	SUCTION PIPE	1
3	6809	SLIDING RING	1
4	59709	SPRING CLIP	1
6	9841	OUTPUT SHAFT CPL.	1
7	36640	CIRCLIP J 47X1,75 DIN472	1
8	62216	SHAFT SEAL 30X47X7 DIN3760	1
9	9150	CIRCLIP J 45x1,75 DIN472	1
10	16220	DEEP GROOVE BALL BEARING 6005 LLU	1
11	9111	SUITABLE DISC 37x47x0.5 DIN988	1
12	7252	SHAFT SEAL 30X42X7 DIN3760 VIA	1
13	52878	SOFT IMPACT RING SHAFT	1
14	52886	SOFT IMPACT RING HOUSING	1
15	27557	DEEP GROOVE BALL BEARING 6203 2RS	1
16	50716	CIRCLIP J 40X1,75 DIN472	1
17	41376	SUITABLE DISC 9x15x0.5 DIN988	1
18	10085	SPACER BUSH	1
19	1479	GEAR 33Z	1
20	21212	CIRCLIP A15 DIN471	1
21	22475	BALL 4	1
22	66571	CYLINDRICAL PIN 4m6x18	1
28	59758	SHIFT ROD	1
29	9262	O-RING 13X2,2	3
32	50260	SCREW EJOT DELTA PT 5,0X100 TORX PLUS 25 GALV.	4
33	10135	GEARBOX HOUSING 2GG IMPACT	1
34	12724	FLAT SEAL	1
35	48249	HEXAGONE SOCKET HEAD SCREW M4X6 DIN7984 GALV.	1
36	22400	DEEP GROOVE BALL BEARING 629	2
37	9973	COUNTERSHAFT I 11/18Z cpl.	1
39	22103	CYLINDRICAL PIN 4X16 DIN 7	2
40	10925	MOTOR COVER 2-GEAR	1
41	10912	SHAFT SEAL 12x19x4 DIN3760A VIA	1
42	42713	DEEP GROOVE BALL BEARING 6201 2RS	1
43	21600	FAN	1
44	8638	ARMATURE 230V	1
45	5116	INSULATING RING	1
46	22681	DEEP GROOVE BALL BEARING 6000 2RS	1
50	23267	BEARING 10/14/12	2
51	1511	COUNTERSHAFT II 19Z	1
52	1594	ADJUSTING SPRING 5X5X50 DIN6885	1
53	1529	DOUBLE GEAR 27/34Z	1
54	8954	GEAR SHIFTING GATE	1



BDB829

ID-Nr.: 9325 from MaNr.3282
also 9502 / 9904 CH

status: 2025.09
replaced: 2024.04

POS	IDNR	DESCRIPTION	qty
56	49684	HANDLE EXTENSION	1
57	15313	HANDLE PA 210MM LG	1
58	22590	BALL 6 DIN5401	1
59	8053	HEXAGONE NUT M5 DIN 985	1
60	56960	CLAMPING SLEEVE 3x6 DIN 1481	2
61	7345	SHIFT LEVER	1
62	57083	PRESSURE SPRING 5X0,8X17,5 D-135	1
63	57992	O-RING 17X2,65	1
64	75382	SWITCHING HANDLE	1
65	9282	O-RING 4X2	1
66	21246	WASHER M5 DIN125 GALV	1
67	8047	HEXAGONE SOCKET HEAD SCREW M5X18 DIN912	1
70	36137	SCREW EJOT DELTA PT 4X80 TORXPLUS GALV	2
71	8042	AIR GUIDE	1
72	9787	STATOR 230V	1
73	45443	MOTOR HOUSING	1
74	45872	CARBON BRUSH	2
75	52894	BRUSH HOLDER A3	2
76	45625	CARBON BRUSH HOLDER COVER	1
77	7340	BRUSH HOLDER COVER WITH BUBBLE	1
78	21030	POLYPLAST SCREW 4,0X12 DIN7981 GALV	2
80	32607	HANDLE CPL.	1
81	20990	SCREW EJOT DELTA PT 4X16 TORXPLUS GALV	5
82	44941	SCREW EJOT DELTA PT 5X40 TORXPLUS GALV	4
83	9264	ELASTIC BUFFER 6-4	4
84	9263	ELASTIC BUFFER 10	1
85	8639	ELECTRONICS	1
86	24844	SWITCH	1
87	9784	CAPACITOR	1
88	17913	CABLE CLAMP	1
89	25221	ANTI-KINK SLEEVE	1
90	6430	CABLE 2x1,5mm	1
90	57539	CABLE WITH PRCD SWITCH 2x1MM ²	only CH - 9502
90	10845	CABLE 2x1,5MM ² CH - TYP102	only CH - 9904
100	9322	TYPE PLATE	1
101	31088	COMPANY LOGO	2
102	14290	WRENCH SW41 DIN894	1
103	43216	WRENCH SW36 DIN894	1
105	6471	CENTERING PIN SINKER	
106	74179	CENTERING PIN DRILLING	
107	15453	SHARPING PLATE	
108	8495	TOOL CASE	



ERSATZTEILZEICHNUNG
SPARE PARTS DRAWING
Diamant-Trockenbohrmaschine
DIAMOND DRY CORING



BDB829 ab/*from* MaNr. 3282
 IDNR. 9325

Stand/*status*: 2025.09

ersetzt/*replaced*: 2024.04

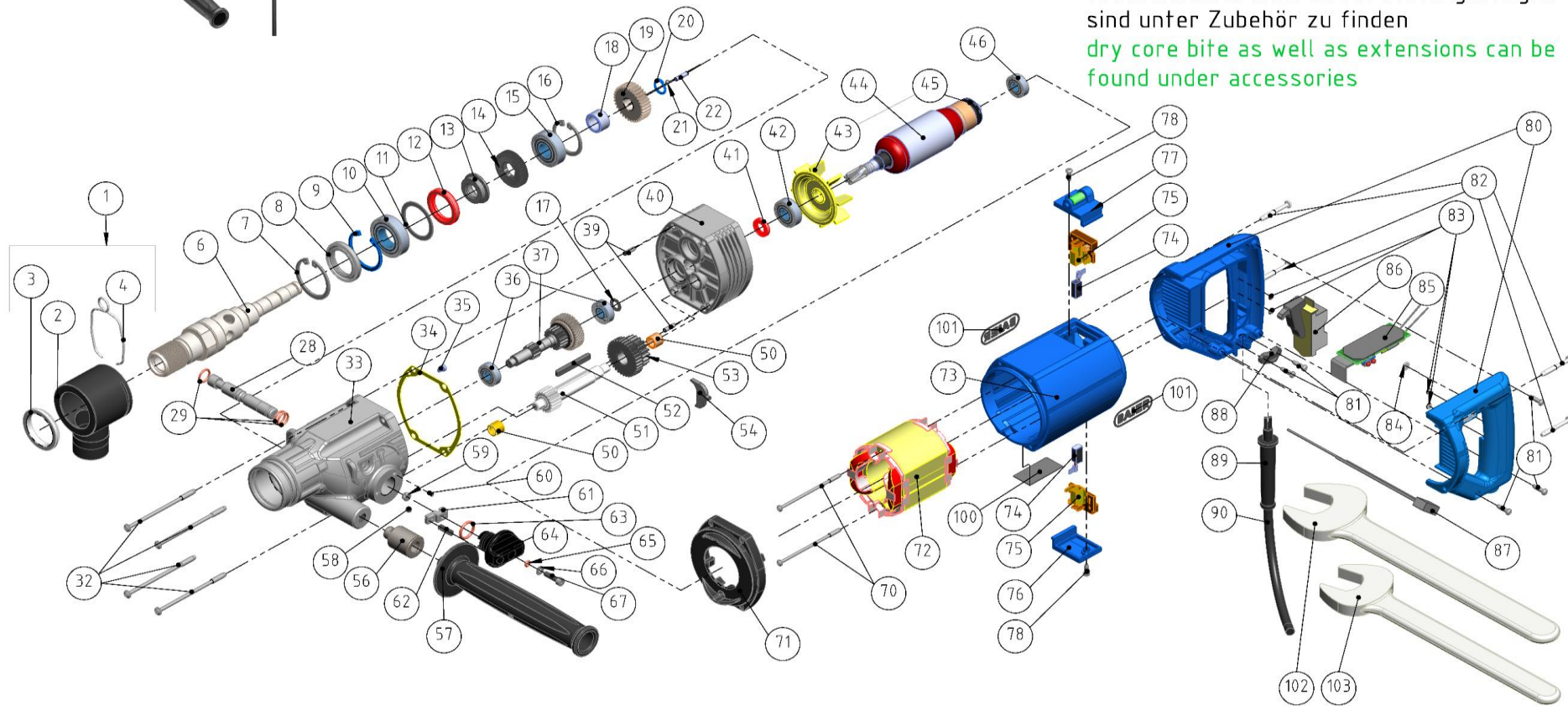

ZUBEHÖR ACCESSORIES	ID-Nr.	POS.
Zentrierstift Dosensenker centering pin sinker	6471	105
Zentrierstift Kernbohren centering pin drilling	74179	106
Schärfplatte sharpening plate	15453	107
Transportkoffer tool case	8495	108

Trockenbohrkronen sowie Verlängerungen
 sind unter Zubehör zu finden
 dry core bite as well as extensions can be
 found under accessories